

**LAKE PLACID DREDGING
AT
ANNE ARUNDEL COUNTY**

APPL. BY: ANNE ARUNDEL COUNTY
DEPARTMENT OF PUBLIC WORKS

VICINITY MAP

DATE: SEPTEMBER 2024 PAGE 1 OF 15

**Main Channel:
24-WL-0055
202460071
104846
9/19/24
MT**

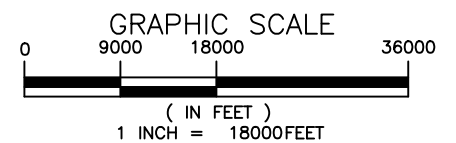

Bayland
Consultants & Designers, Inc.
"Integrating Engineering and Environment"

7455 New Ridge Road, Suite 1 Phone: (410) 694-9401
Hanover, Maryland 21076 Fax: (410) 694-9405
www.baylandinc.com

MAGOTHY RIVER
FLOOD
END

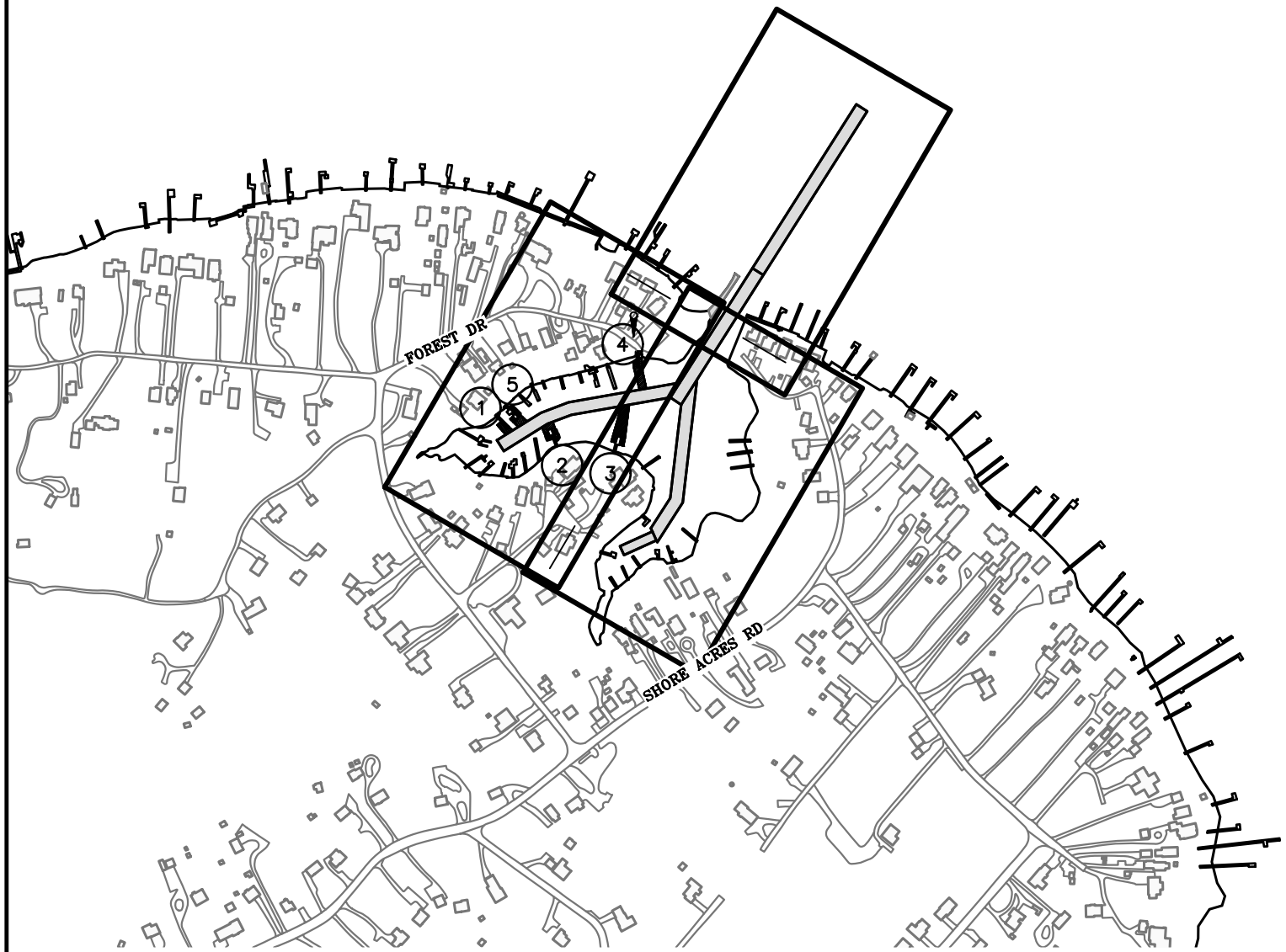

LAKE PLACID DREDGING
AT
ANNE ARUNDEL COUNTY

Main Channel:
24-WL-0055
202460071
104846
9/19/24
MT

APPL. BY: ANNE ARUNDEL COUNTY
DEPARTMENT OF PUBLIC WORKS

SPUR KEY SHEET PAGE 2 OF 15

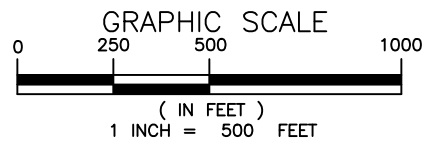

Bayland
Consultants & Designers, Inc.
"Integrating Engineering and Environment"

7455 New Ridge Road, Suite 1 Phone: (410) 694-9401
Hanover, Maryland 21076 Fax: (410) 694-9405
www.baylandinc.com

Z:\5_20401_LAKE_PLACID_DREDGING\CAD FILES\SHEET FILES\SPURS\5_20401_SPUR_KEY.DWG



MAGOTHY RIVER

MAIN CHANNEL SEGMENT "A"
 600' X 40' TO -5.0' MLW
 CHANNEL OUTLINE REPRESENTS BOTTOM WIDTH.
 FOR TOTAL IMPACT SEE TYPICAL CROSS
 SECTION AND CHANNEL DATA TABLE.

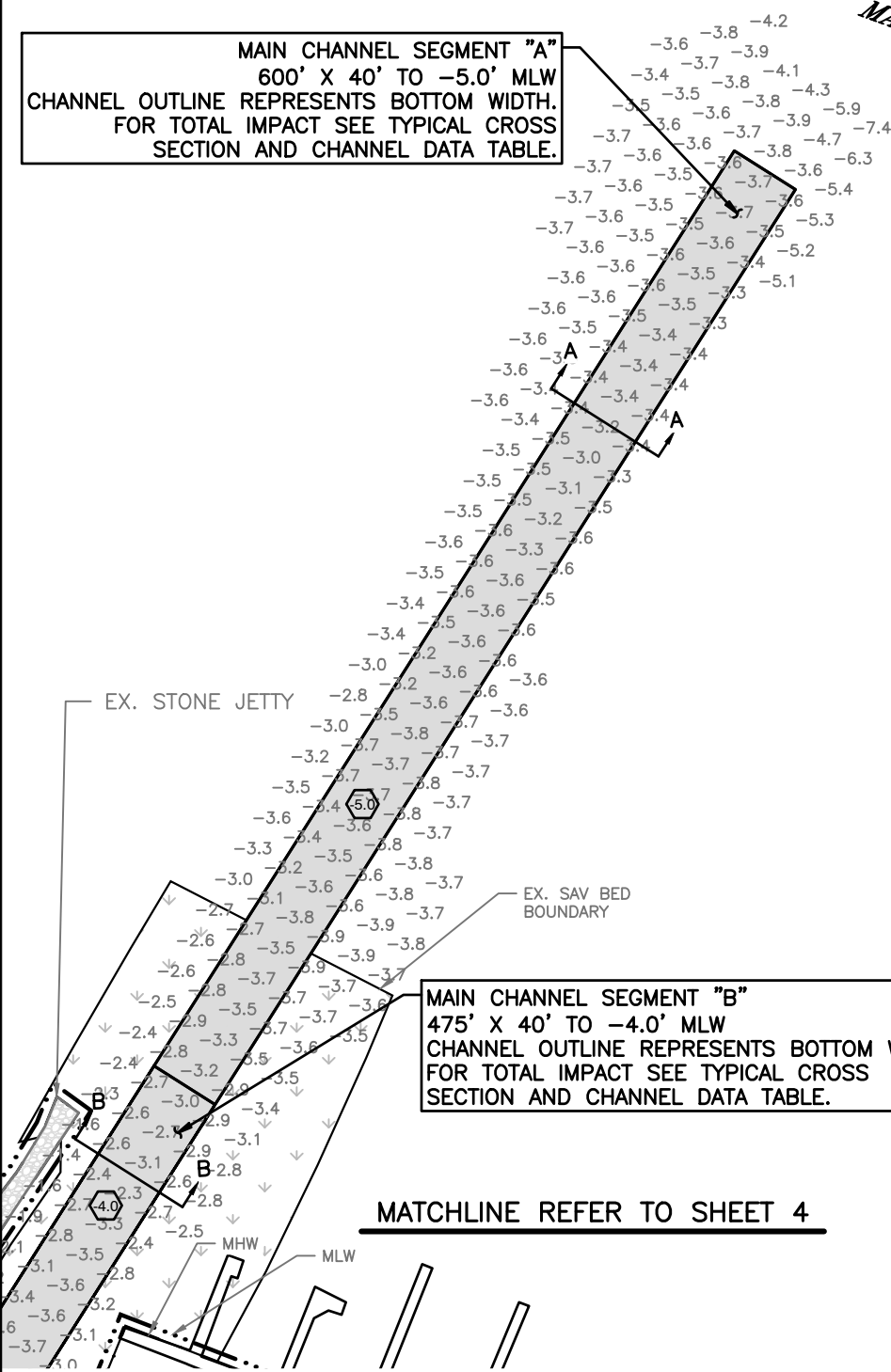

MAIN CHANNEL SEGMENT "B"
 475' X 40' TO -4.0' MLW
 CHANNEL OUTLINE REPRESENTS BOTTOM WIDTH.
 FOR TOTAL IMPACT SEE TYPICAL CROSS
 SECTION AND CHANNEL DATA TABLE.

Main Channel:
24-WL-0055
202460071
104846
9/19/24
MT

LEGEND	
	PREVIOUSLY DREDGED CHANNEL
	PROPOSED COUNTY CHANNEL
-3.6	SOUNDINGS
	PROPOSED CHANNEL DEPTH
	PROPOSED SEDIMENT SAMPLE LOCATION
	PROPOSED SPUR CHANNEL
①	SPUR NUMBER
	EXISTING SHORELINE
	APPROX. PROPERTY LINES
	COMMUNITY BOAT RAMP
	EXISTING BOAT LIFT
○	EXISTING PILING
●	PROPOSED PILING
- · -	APPROX MHW
- · · -	APPROX MLW

SAV LEGEND	
	COMPOSITE SAV BED FROM SPRING AND SUMMER SAV SURVEY 2023
SPRING SURVEY DATE: MAY 12, 2023	
SUMMER SURVEY DATE: JULY 18, 2023	

**LAKE PLACID DREDGING
 AT
 ANNE ARUNDEL COUNTY**

APPL. BY: ANNE ARUNDEL COUNTY
 DEPARTMENT OF PUBLIC WORKS

MAIN CHANNEL PLAN

DATE: SEPTEMBER 2024 **PAGE 3 OF 15**

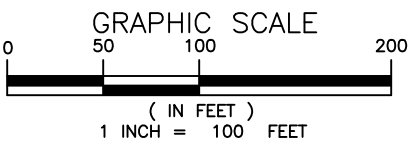

NOTE:
 BASEMAP TAKEN FROM ANNE ARUNDEL COUNTY
 2021 PLANIMETRICS AND 2020 IMAGERY.

Bayland
 Consultants & Designers, Inc.
 "Integrating Engineering and Environment"

7455 New Ridge Road, Suite 1 Phone: (410) 694-9401
 Hanover, Maryland 21076 Fax: (410) 694-9405
 www.baylandinc.com

Z:\5_20401_LAKE_PLACID_DREDGING\CAD FILES\SHEET FILES\5_20401_JPA03.DWG

MAIN CHANNEL SEGMENT "A"
 600' X 40' TO -5.0' MLW
 CHANNEL OUTLINE REPRESENTS
 BOTTOM WIDTH. FOR TOTAL IMPACT
 SEE TYPICAL CROSS SECTION AND
 CHANNEL DATA TABLE.

MAIN CHANNEL SEGMENT "B"
 475' X 40' TO -4.0' MLW
 CHANNEL OUTLINE REPRESENTS
 BOTTOM WIDTH. FOR TOTAL IMPACT
 SEE TYPICAL CROSS SECTION AND
 CHANNEL DATA TABLE.

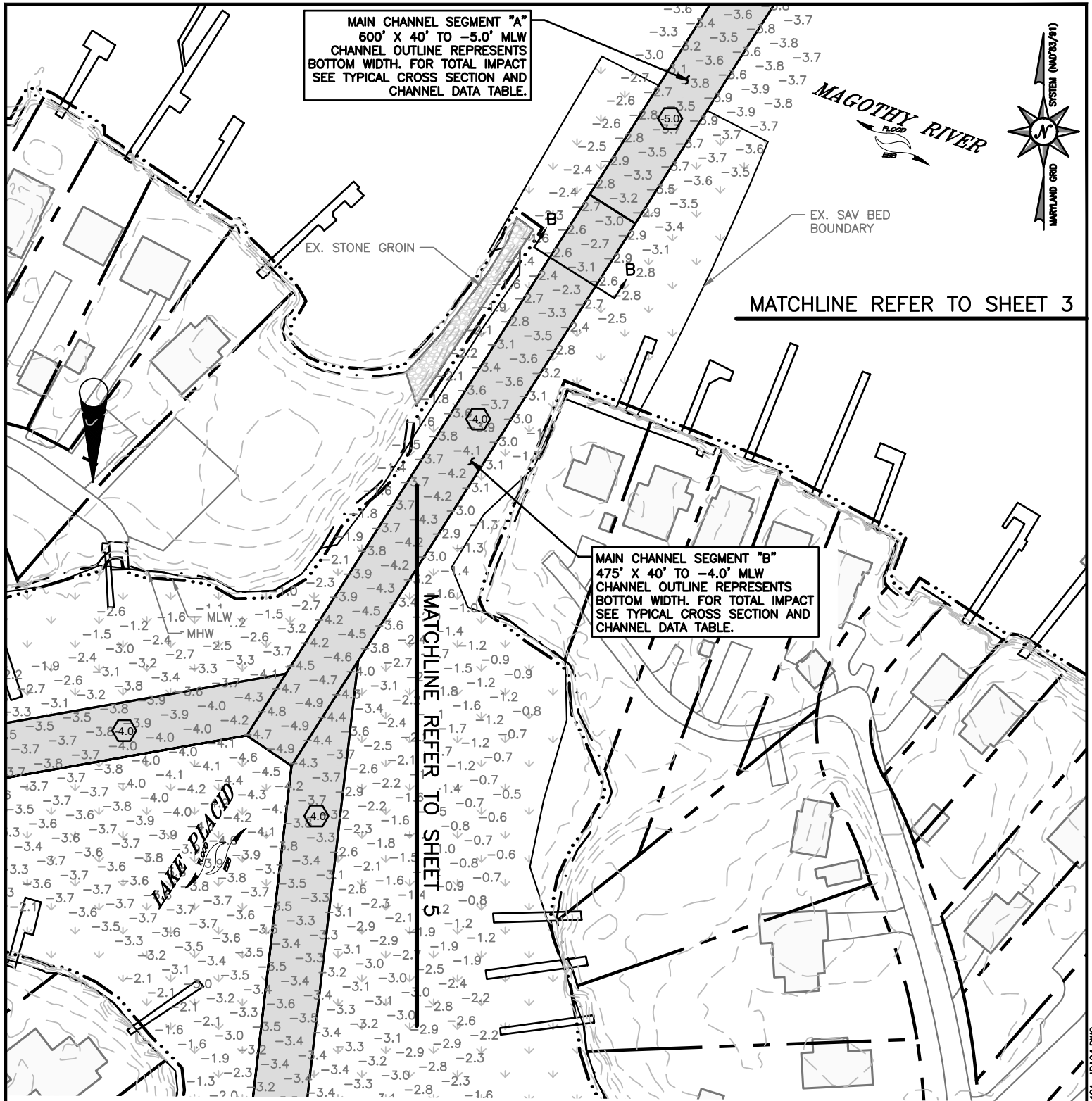

**LAKE PLACID DREDGING
 AT
 ANNE ARUNDEL COUNTY**

**Main Channel:
 24-WL-0055
 202460071
 104846
 9/19/24
 MT**

APPL. BY: ANNE ARUNDEL COUNTY
 DEPARTMENT OF PUBLIC WORKS

MAIN CHANNEL PLAN

DATE: SEPTEMBER 2024 **PAGE 4 OF 15**

NOTE:
 BASEMAP TAKEN FROM ANNE ARUNDEL COUNTY
 2016 PLANIMETRICS AND 2020 IMAGERY.

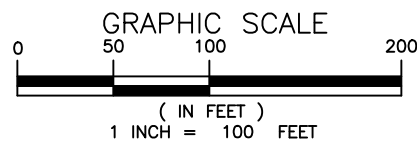

Bayland
 Consultants & Designers, Inc.
 "Integrating Engineering and Environment"

7455 New Ridge Road, Suite 1 Phone: (410) 694-9401
 Hanover, Maryland 21076 Fax: (410) 694-9405
 www.baylandinc.com

Z:\5_20401_LAKE_PLACID_DREDGING\CAD FILES\SHEET FILES\5_20401_JPA04.DWG

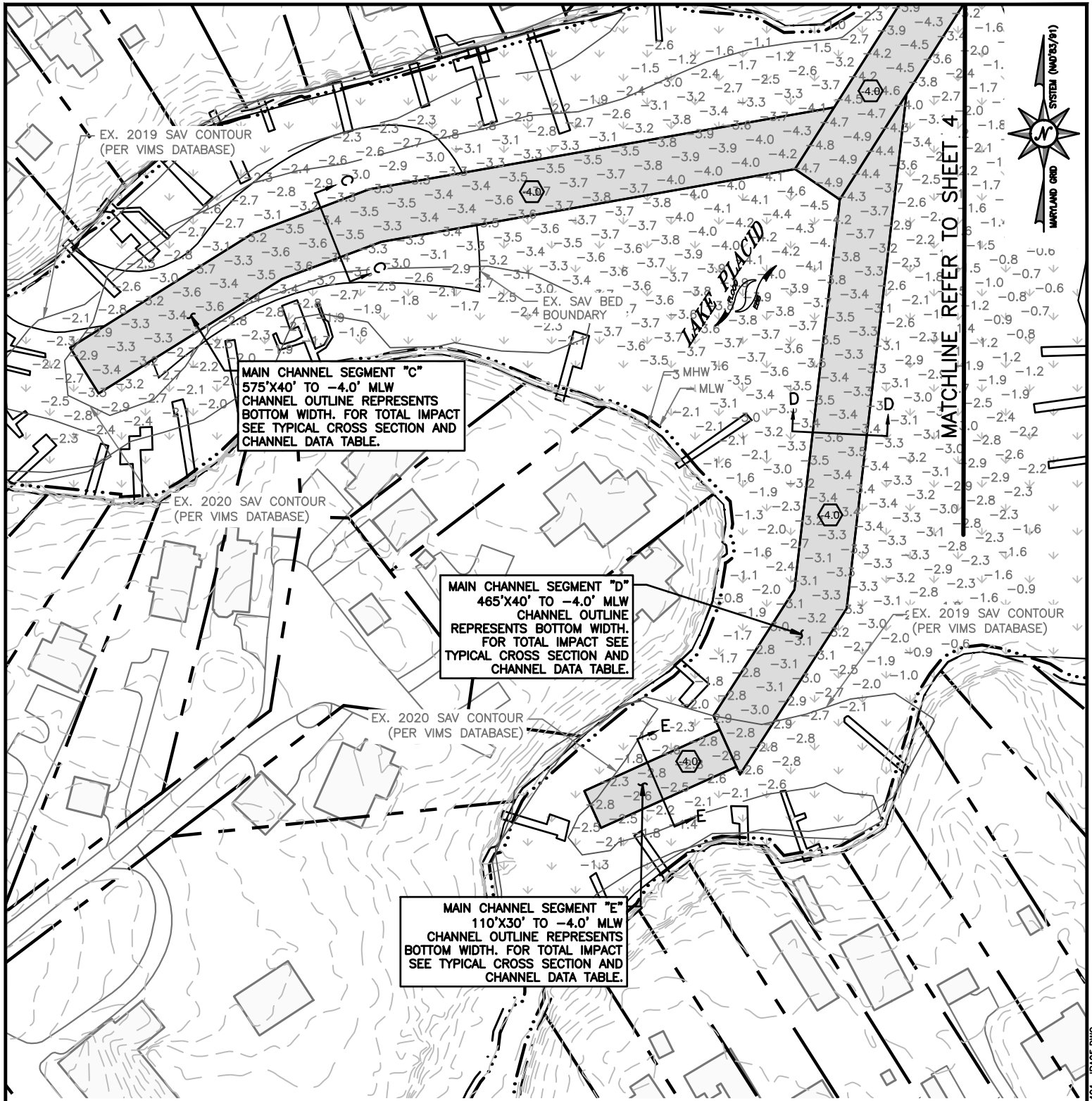

LAKE PLACID DREDGING
AT
ANNE ARUNDEL COUNTY

Main Channel:
24-WL-0055
202460071
104846
9/19/24
MT

APPL. BY: ANNE ARUNDEL COUNTY
DEPARTMENT OF PUBLIC WORKS

MAIN CHANNEL PLAN

DATE: SEPTEMBER 2024 **PAGE 5 OF 15**

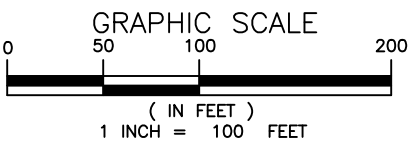

NOTE:
BASEMAP TAKEN FROM ANNE ARUNDEL COUNTY
2016 PLANIMETRICS AND 2020 IMAGERY.

Bayland
Consultants & Designers, Inc.
"Integrating Engineering and Environment"

7455 New Ridge Road, Suite 1 Phone: (410) 694-9401
Hanover, Maryland 21076 Fax: (410) 694-9405
www.baylandinc.com

Z:\5-20401_LAKE_PLACID_DREDGING\CAD FILES\SHEET FILES\5_20401_JPA05.DWG

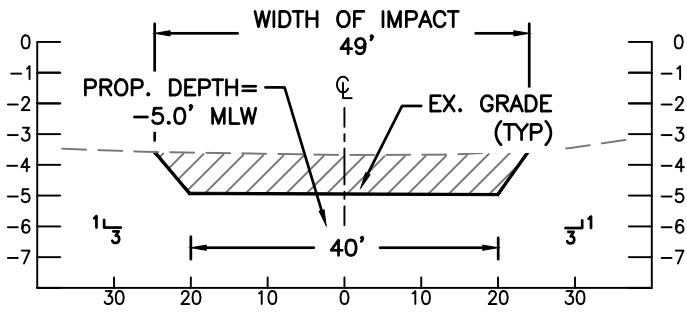

SECTION A-A
SCALE: NTS

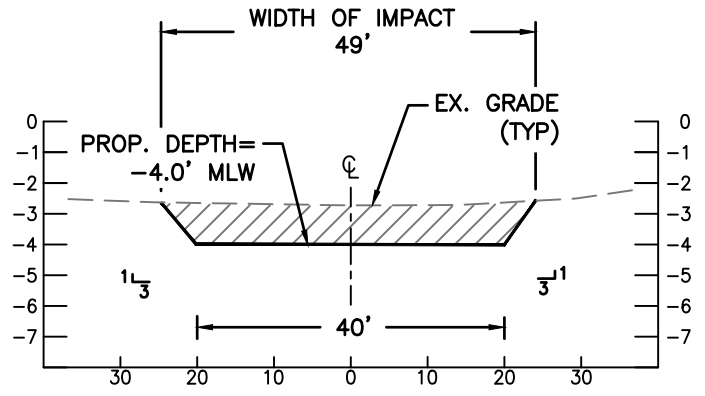

SECTION B-B
SCALE: NTS

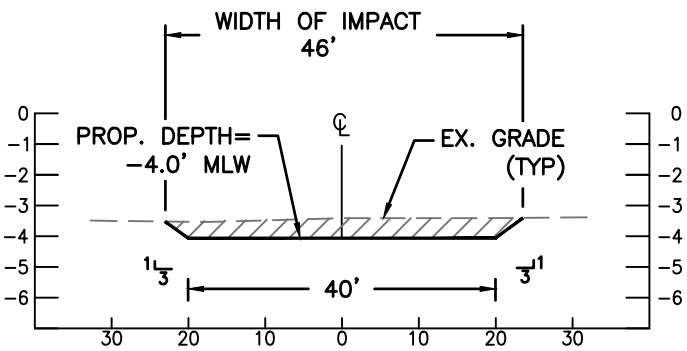

SECTION C-C
SCALE: NTS

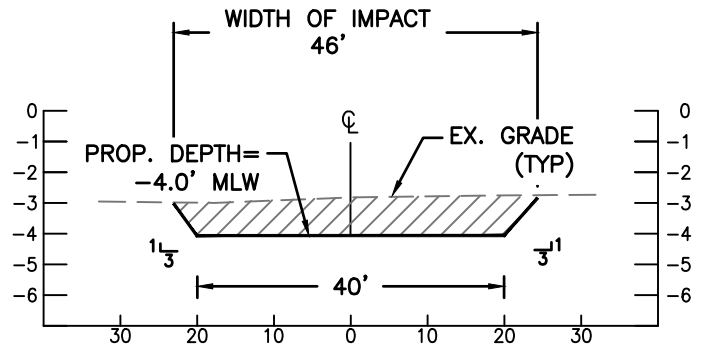

SECTION D-D
SCALE: NTS

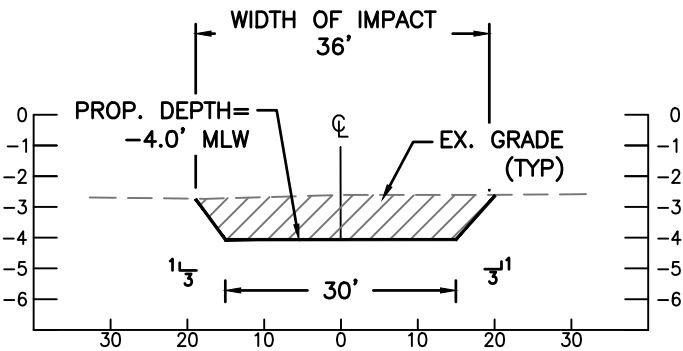

SECTION E-E
SCALE: NTS

LAKE PLACID DREDGING
AT
ANNE ARUNDEL COUNTY

Main Channel:
24-WL-0055
202460071
104846
9/19/24
MT

APPL. BY: ANNE ARUNDEL COUNTY
DEPARTMENT OF PUBLIC WORKS

CHANNEL SECTIONS

DATE: SEPTEMBER 2024 | PAGE 6 OF 15

CHANNEL DETAILS				
SEGMENT	LENGTH (FT)	WIDTH (FT)	DEPTH (FT)	VOLUME (CY)
A	600	40	-5.0	1351
B	475	40	-4.0	277
C	575	40	-4.0	382
D	465	40	-4.0	445
E	110	30	-4.0	164
TOTAL MAIN CHANNEL LENGTH				2,225 LF
TOTAL MAIN CHANNEL VOLUME				2,619 CY
TOTAL MAIN CHANNEL AREA OF IMPACT				105,150 SF = 2.41 AC
TOTAL NEW AREA OF DREDGING				0
TOTAL MAIN CHANNEL AREA OF IMPACT TO 2023 SAV				67,411 SF = 1.55 AC
TOTAL MAIN CHANNEL AREA OF IMPACT TO 2019 SAV				4,170 SF = 0.10 AC
TOTAL MAIN CHANNEL AREA OF IMPACT TO 2020 SAV				135 SF = 0.00 AC

NOTES:

1. BASEMAP COMPILED FROM ANNE ARUNDEL COUNTY 2016 PLANIMETRICS AND 2020 IMAGERY.
2. TIDAL RANGE IS 1.0 FEET.
3. BATHYMETRY FROM BAYLAND SURVEY DATED NOVEMBER 01, 2022.
4. SOUNDINGS ARE IN FEET AND REFER TO MLW.
5. THE LAKE PLACID CHANNEL PROPOSED FOR MAINTENANCE DREDGING WAS PREVIOUSLY PERMITTED UNDER WETLANDS LICENSE NO. 97-0105(R).
6. THESE ARE PERMIT DRAWINGS ONLY. DESIGN DRAWINGS WILL BE PREPARED SEPARATELY.

**LAKE PLACID DREDGING
AT
ANNE ARUNDEL COUNTY**

**Main Channel:
24-WL-0055
202460071
104846
9/19/24
MT**

APPL. BY: ANNE ARUNDEL COUNTY
DEPARTMENT OF PUBLIC WORKS

CHANNEL DETAILS



Z:\5_20401_LAKE_PLACID_DREDGING\CAD FILES\SHEET FILES\5_20401_JPA07.DWG

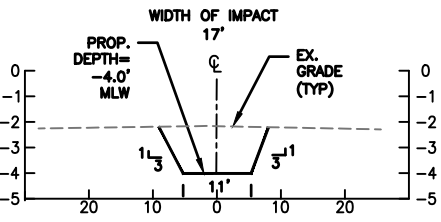

APPLICATION BY:
MICHAEL EBERSBERGER
971 FOREST DRIVE
ARNOLD, MD 21012

SUNDERLAND,
 MICHAEL D.
 901 LAKE DRIVE

FOX JR, DONALD G.
 FOX, DOLORES A.
 979 FOREST DR

WARD, DAVID J. TRUSTEE
 WARD, JILL C. TRUSTEE
 983 FOREST DR

EX. 2019 SAV CONTOUR
 (PER VIMS DATABASE)

EX. BOAT LIFT

PR. SPUR
 DREDGING
 TO -4.0' MLW

EX. SAV BED
 BOUNDARY

SARVINAS, GEORGE W.
 SARVINAS, ELIZABETH A.
 1014 SMITH DRIVE

MAIN CHANNEL SEGMENT "C"
 575'X40' TO -4.0' MLW

LONG, ROBERT P. TRUSTEE
 LONG, MELINDA M. TRUSTEE
 913 LAKE DRIVE

FELDMAN, ROGER A.
 FELDMAN, CYNDY A..
 1012 SMITH DR

EX. 2020 SAV CONTOUR
 (PER VIMS DATABASE)

SMYSER, JAMILYN J.
 1010 SMITH DR

HARE, JAMES O.
 HARE, KATHERINE A.
 921 LAKE DRIVE

NGUYEN, DUNG VAN
 925 LAKE DRIVE

MITCHELL, BRUCE C.
 MITCHELL, LORI G.
 1008 SMITH DR

SPUR DATA

AREA = 893 SF
 VOLUME = 56 CY
 2023 SAV IMPACT = NONE
 2019 SAV IMPACT = 428 SF
 2020 SAV IMPACT = 338 SF

SAV LEGEND	
	COMPOSITE SAV BED FROM SPRING AND SUMMER SAV SURVEY 2023
	SPRING SURVEY DATE: MAY 12, 2023
	SUMMER SURVEY DATES: JULY 18, 2023

NOTE:

1. ADDITIONAL DETAILS INCLUDING SIDE SLOPES AND CROSS SECTION HAVE BEEN ADDED TO GRAPHICALLY REPRESENT IMPACTS.

LEGEND

- 1.0 EXISTING DEPTH
- EXISTING PILING
- PROPOSED PILING
- BOTTOM CUT AREA
- SIDE SLOPE AREA

Main Channel:
24-WL-0055
202460071
104846
9/19/24
MT

NOTES:

1. TIDAL RANGE IS 1.0 FEET.
2. SOUNDINGS ARE IN FEET AND REFER TO MLW.
3. MATERIAL WILL BE PLACED AT ONE OF THE APPROVED COUNTY DMP SITES.
4. THESE ARE PERMIT DRAWINGS ONLY. DESIGN DRAWINGS WILL BE PREPARED SEPARATELY.
5. BASEMAP TAKEN FROM ANNE ARUNDEL COUNTY 2020 PLANIMETRICS AND 2020 IMAGERY.

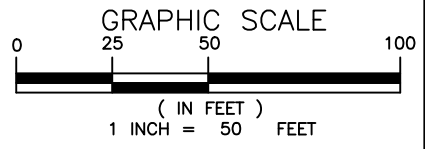

Bayland
 Consultants & Designers, Inc.
 "Integrating Engineering and Environment"
 7455 New Ridge Road, Suite T Phone: (410) 694-9401
 Hanover, Maryland 21076 Fax: (410) 694-9405
 www.baylandinc.com

LAKE PLACID SPURS
 SPUR 1
 MICHAEL EBERSBERGER
 971 FOREST DRIVE
 ARNOLD, MD 21012
 SEPTEMBER 2024

Z:\5_20401_LAKE_PLACID_DREDGING\CAD FILES\SHEET FILES\SPURS\5_20401_SPUR02.DWG

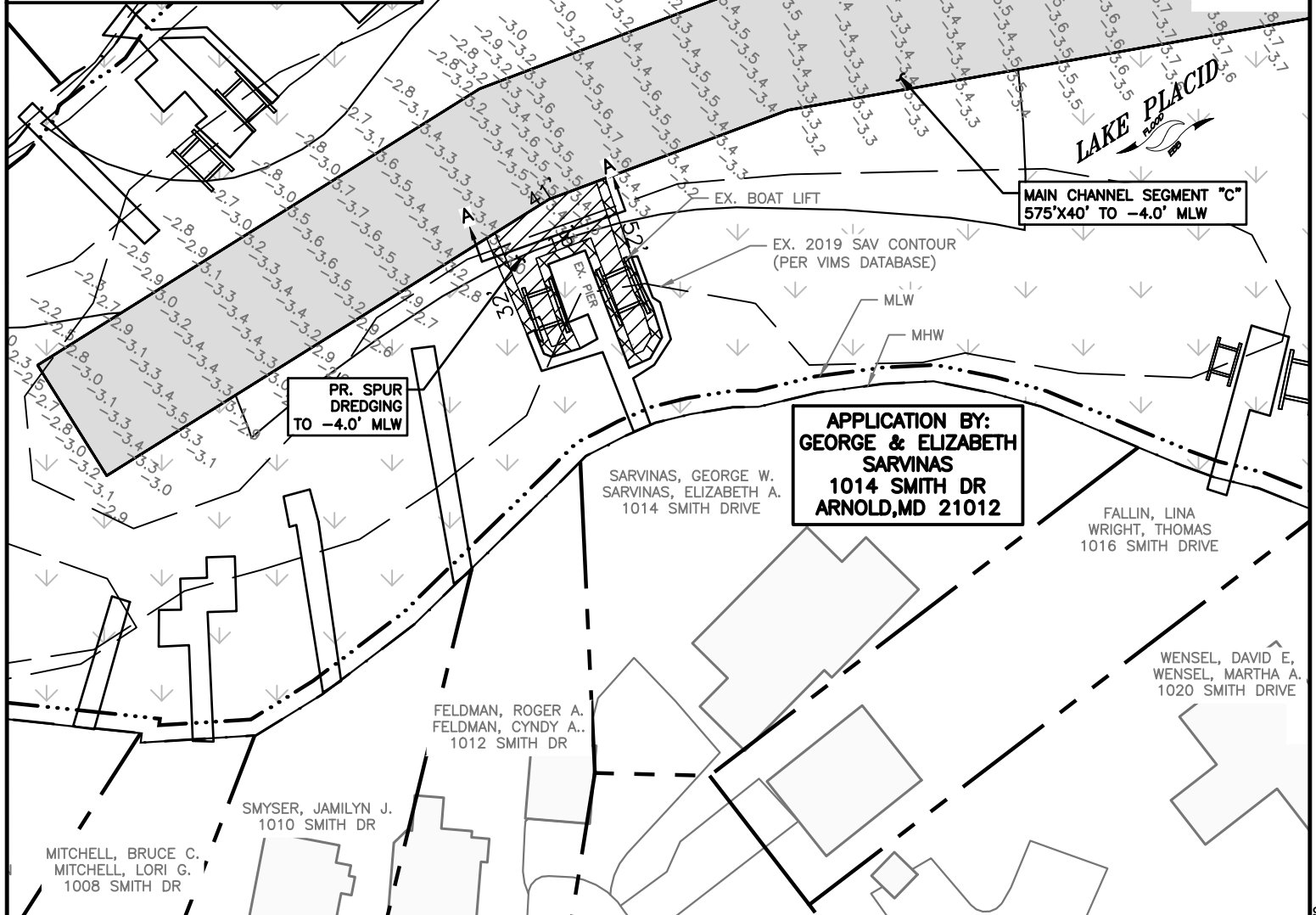
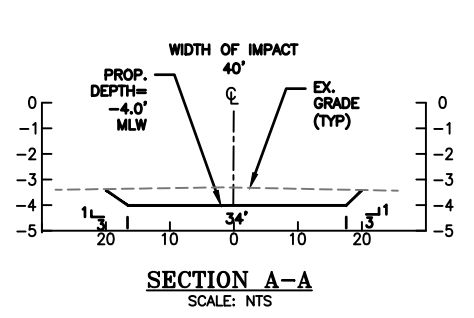

APPLICATION BY:
GEORGE & ELIZABETH SARVINAS
1014 SMITH DR
ARNOLD, MD 21012

PR. SPUR DREDGING TO -4.0' MLW

MAIN CHANNEL SEGMENT "C"
575'X40' TO -4.0' MLW

SPUR DATA

AREA = 1,512 SF
 VOLUME = 63 CY
 2023 SAV IMPACT = 1,020 SF
 2019 SAV IMPACT = 873 SF
 2020 SAV IMPACT = 0 SF

LEGEND

- 1.0 EXISTING DEPTH
- EXISTING PILING
- PROPOSED PILING

SAV LEGEND	
	COMPOSITE SAV BED FROM SPRING AND SUMMER SAV SURVEY 2023
	SPRING SURVEY DATE: MAY 12, 2023
	SUMMER SURVEY DATES: JULY 18, 2023

Bottom Cut Area
Side Slope Area

Main Channel:
24-WL-0055
202460071
104846
9/19/24
MT

NOTE:
 1. ADDITIONAL DETAILS INCLUDING SIDE SLOPES AND CROSS SECTION HAVE BEEN ADDED TO GRAPHICALLY REPRESENT IMPACTS.

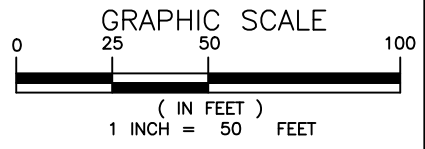

- NOTES:**
- TIDAL RANGE IS 1.0 FEET.
 - SOUNDINGS ARE IN FEET AND REFER TO MLW.
 - MATERIAL WILL BE PLACED AT ONE OF THE APPROVED COUNTY DMP SITES.
 - THESE ARE PERMIT DRAWINGS ONLY. DESIGN DRAWINGS WILL BE PREPARED SEPARATELY.
 - BASEMAP TAKEN FROM ANNE ARUNDEL COUNTY 2020 PLANIMETRICS AND 2020 IMAGERY.

Bayland
 Consultants & Designers, Inc.
"Integrating Engineering and Environment"
 7455 New Ridge Road, Suite T Phone: (410) 694-9401
 Hanover, Maryland 21076 Fax: (410) 694-9405
 www.baylandinc.com

LAKE PLACID SPURS
 SPUR 2
 ELIZABETH SARVINAS
 1014 SMITH DR.
 ARNOLD, MD 21012
 SEPTEMBER 2024

Z:\5-20401_LAKE_PLACID_DREDGING\CAD FILES\SHEET FILES\SPURS\5_20401_SPUR03.DWG

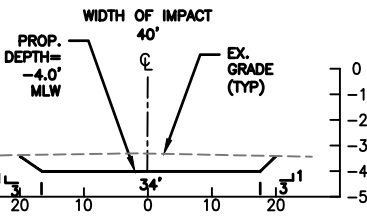

SECTION A-A
SCALE: NTS

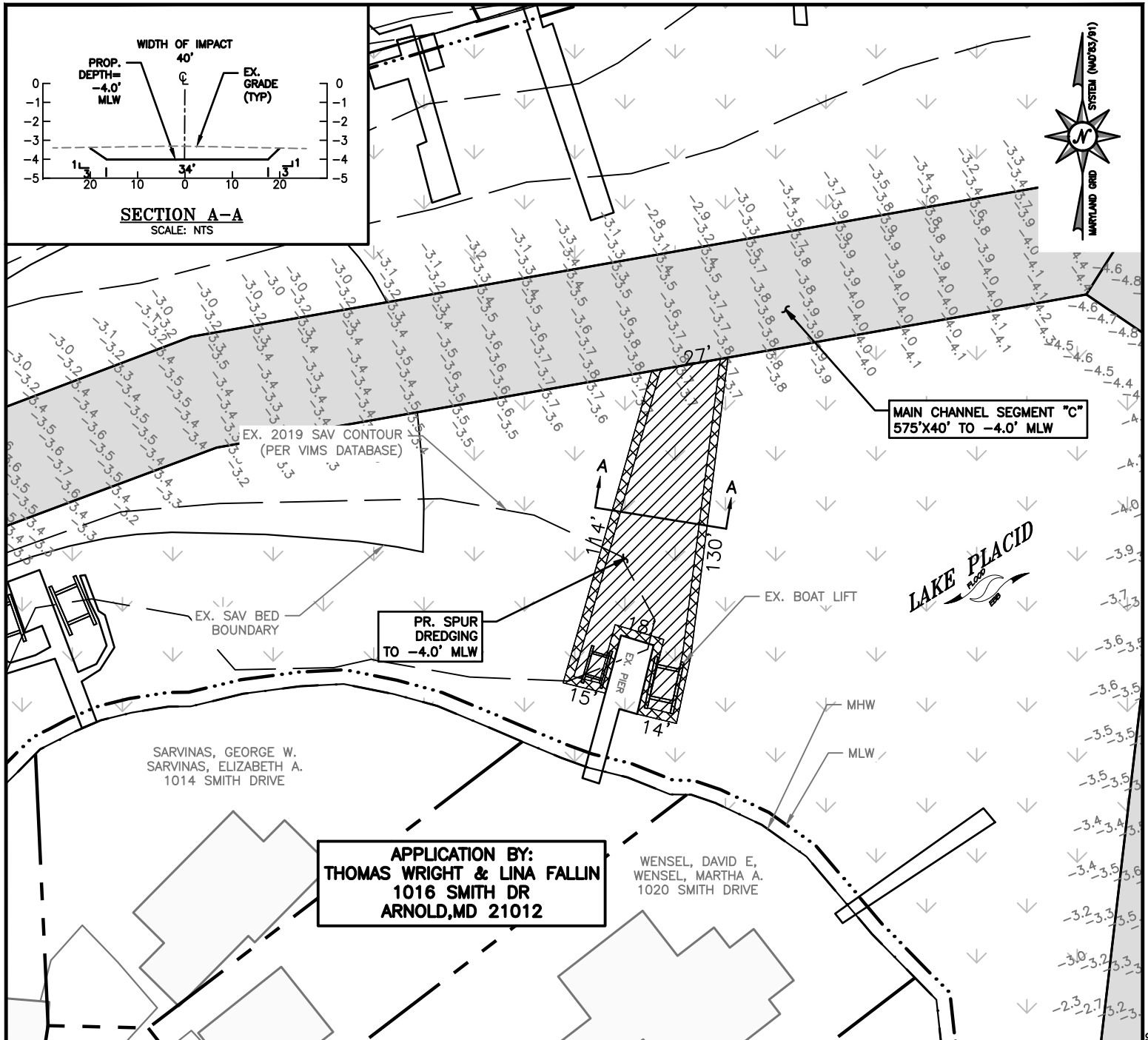

MAIN CHANNEL SEGMENT "C"
575'x40' TO -4.0' MLW

PR. SPUR DREDGING
TO -4.0' MLW

APPLICATION BY:
THOMAS WRIGHT & LINA FALLIN
1016 SMITH DR
ARNOLD, MD 21012



SPUR DATA

AREA = 3,917 SF
VOLUME = 83 CY
2023 SAV IMPACT = 3,745 SF
2019 SAV IMPACT = 755 SF

LEGEND

- 1.0 EXISTING DEPTH
- EXISTING PILING
- PROPOSED PILING

SAV LEGEND

☉ COMPOSITE SAV BED FROM SPRING AND SUMMER SAV SURVEY 2023
SPRING SURVEY DATE: MAY 12, 2023
SUMMER SURVEY DATES: JULY 18, 2023

- BOTTOM CUT AREA **Main Channel: 24-WL-0055 202460071 104846 9/19/24 MT**
- SIDE SLOPE AREA

NOTE:

1. ADDITIONAL DETAILS INCLUDING SIDE SLOPES AND CROSS SECTION HAVE BEEN ADDED TO GRAPHICALLY REPRESENT IMPACTS.

NOTES:

1. TIDAL RANGE IS 1.0 FEET. **PAGE 10 OF 15**
2. SOUNDINGS ARE IN FEET AND REFER TO MLW.
3. MATERIAL WILL BE PLACED AT ONE OF THE APPROVED COUNTY DMP SITES.
4. THESE ARE PERMIT DRAWINGS ONLY. DESIGN DRAWINGS WILL BE PREPARED SEPARATELY.
5. BASEMAP TAKEN FROM ANNE ARUNDEL COUNTY 2020 PLANIMETRICS AND 2020 IMAGERY.

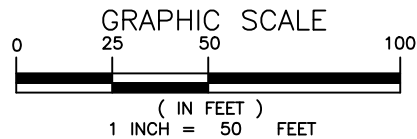

Bayland
Consultants & Designers, Inc.
"Integrating Engineering and Environment"
7455 New Ridge Road, Suite T Phone: (410) 694-9401
Hanover, Maryland 21076 Fax: (410) 694-9405
www.baylandinc.com

LAKE PLACID SPURS
SPUR 3
THOMAS WRIGHT & LINA FALLIN
1016 SMITH DR.
ARNOLD, MD 21012
SEPTEMBER 2024

Z:\5-20401_LAKE_PLACID_DREDGING\CAD FILES\SHEET FILES\SPURS\5-20401_SPUR04.DWG



**APPLICATION BY:
SHORE ACRES IMPROVEMENT ASSOC.
P.O. BOX 12
ARNOLD, MD 21012**

**PR. SPUR DREDGING
TO -3.5' MLW
PREVIOUSLY
AUTHORIZED UNDER
93-WL-1659**

**PR. SPUR
DREDGING
TO -4.0' MLW**

**MAIN CHANNEL SEGMENT "B"
475' X 40' TO -4.0' MLW**

**MAIN CHANNEL SEGMENT "C"
575' X 40' TO -4.0' MLW**

**MAIN CHANNEL SEGMENT "D"
465' X 40' TO -4.0' MLW**

SECTION A-A
SCALE: NTS

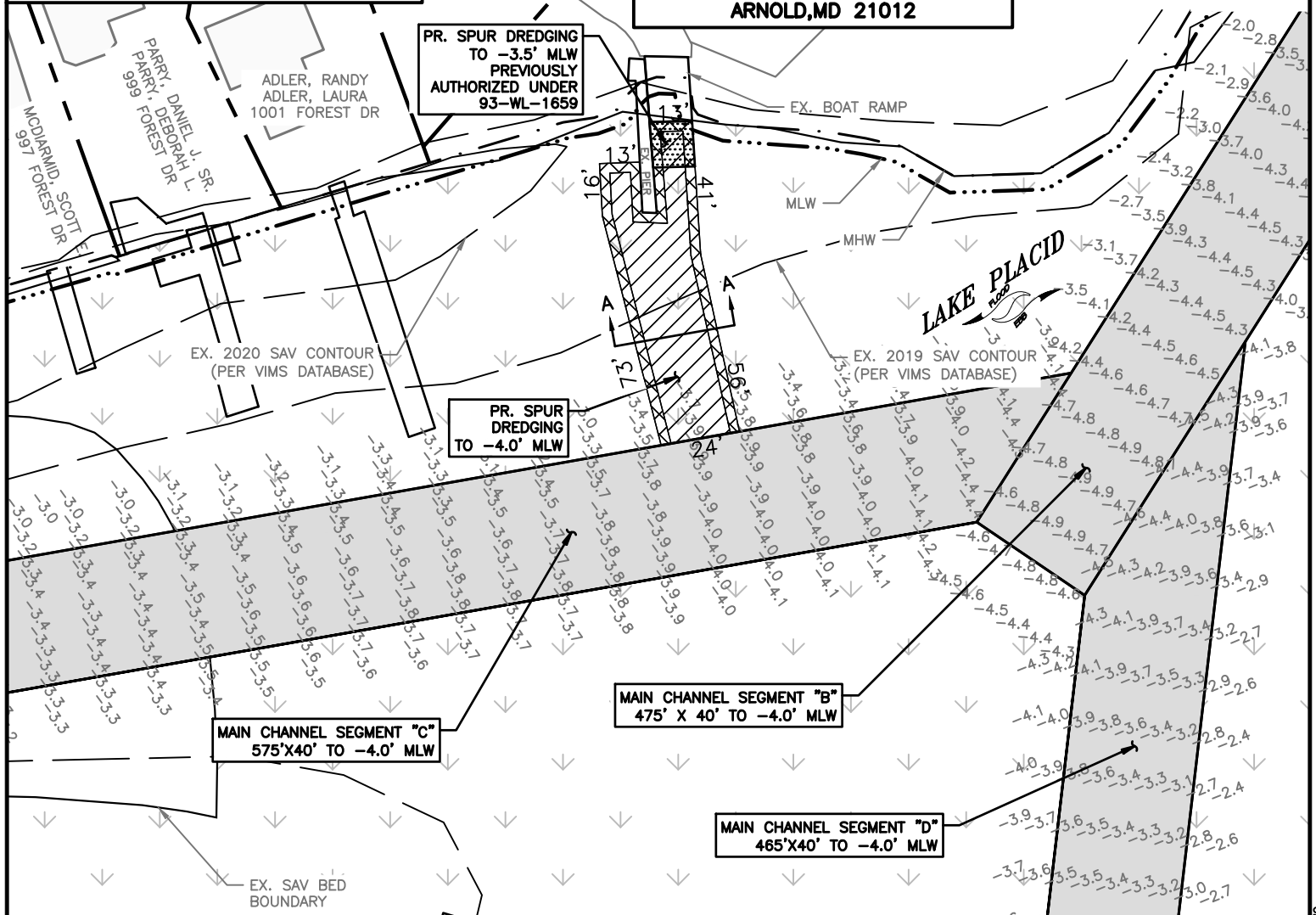
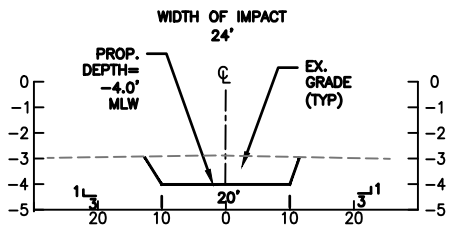

SPUR DATA

AREA = 2,384 SF (2,203 SF NEW)
VOLUME = 98 CY
2023 SAV IMPACT = 2,384 SF
2019 SAV IMPACT = 1,322 SF
2020 SAV IMPACT = 0 SF

LEGEND

- 1.0 EXISTING DEPTH
- EXISTING PILING
- PROPOSED PILING
- ▨ BOTTOM CUT AREA
- ▩ SIDE SLOPE AREA

SAV LEGEND

☉ COMPOSITE SAV BED FROM SPRING AND SUMMER SAV SURVEY 2023
SPRING SURVEY DATE: MAY 12, 2023
SUMMER SURVEY DATES: JULY 18, 2023

**Main Channel:
24-WL-0055
202460071
104846
9/19/24
MT**

NOTE:

1. ADDITIONAL DETAILS INCLUDING SIDE SLOPES AND CROSS SECTION HAVE BEEN ADDED TO GRAPHICALLY REPRESENT IMPACTS.

NOTES:

1. TIDAL RANGE IS 1.0 FEET.
2. SOUNDINGS ARE IN FEET AND REFER TO MLW.
3. MATERIAL WILL BE PLACED AT ONE OF THE APPROVED COUNTY DMP SITES.
4. THESE ARE PERMIT DRAWINGS ONLY. DESIGN DRAWINGS WILL BE PREPARED SEPARATELY.
5. BASEMAP TAKEN FROM ANNE ARUNDEL COUNTY 2020 PLANIMETRICS AND 2020 IMAGERY.

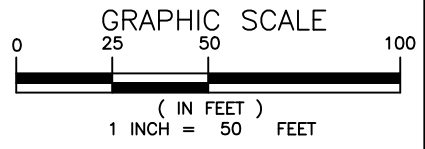

Bayland
Consultants & Designers, Inc.
"Integrating Engineering and Environment"
7455 New Ridge Road, Suite T Phone: (410) 694-9401
Hanover, Maryland 21076 Fax: (410) 694-9405
www.baylandinc.com

LAKE PLACID SPURS
SPUR 4
SHORE ACRES IMPROVEMENT ASSOC.
P.O. BOX 12
ARNOLD, MD 21012
SEPTEMBER 2024

Z:\5-20401_LAKE_PLACID_DREDGING\CAD FILES\SHEET FILES\SPURS\5-20401_SPUR05.DWG

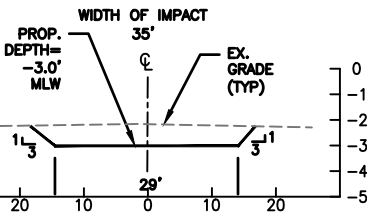

SECTION A-A
SCALE: NTS

APPLICATION BY:
DONALD FOX
979 FOREST DRIVE
ARNOLD, MD 21012

FOX JR, DONALD G.
FOX, DOLORES A.
979 FOREST DR

PR. SPUR
DREDGING
TO -3.0' MLW

EX. 2019 SAV CONTOUR
(PER VIMS DATABASE)

SUNDERLAND,
MICHAEL D.
901 LAKE DRIVE

MAIN CHANNEL SEGMENT "C"
575'X40' TO -4.0' MLW

EX. 2020 SAV CONTOUR
(PER VIMS DATABASE)

LONG, ROBERT P. TRUSTEE
LONG, MELINDA M. TRUSTEE
913 LAKE DRIVE

SARVINAS, GEORGE W.
SARVINAS, ELIZABETH A.
1014 SMITH DRIVE

FELDMAN, ROGER A.
FELDMAN, CANDY A.
1012 SMITH DR

SPUR DATA

AREA = 1,377 SF
VOLUME = 31 CY
2023 SAV IMPACT = 832 SF
2019 SAV IMPACT = 284 SF
2020 SAV IMPACT = 434 SF

SAV LEGEND	
	COMPOSITE SAV BED FROM SPRING AND SUMMER SAV SURVEY 2023
SPRING SURVEY DATE: MAY 12, 2023	
SUMMER SURVEY DATES: JULY 18, 2023	

NOTE:

1. ADDITIONAL DETAILS INCLUDING SIDE SLOPES AND CROSS SECTION HAVE BEEN ADDED TO GRAPHICALLY REPRESENT IMPACTS.

LEGEND

- 1.0 EXISTING DEPTH
- EXISTING PILING
- PROPOSED PILING
-
-

Main Channel:
24-WL-0055
202460071
104846
9/19/24
MT

NOTES:

1. TIDAL RANGE IS 1.0 FEET.
2. SOUNDINGS ARE IN FEET AND REFER TO MLW.
3. MATERIAL WILL BE PLACED AT ONE OF THE APPROVED COUNTY DMP SITES.
4. THESE ARE PERMIT DRAWINGS ONLY. DESIGN DRAWINGS WILL BE PREPARED SEPARATELY.
5. BASEMAP TAKEN FROM ANNE ARUNDEL COUNTY 2020 PLANIMETRICS AND 2020 IMAGERY.

PAGE 12 OF 15

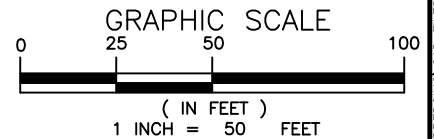

Bayland
Consultants & Designers, Inc.
"Integrating Engineering and Environment"
7455 New Ridge Road, Suite T Phone: (410) 694-9401
Hanover, Maryland 21076 Fax: (410) 694-9405
www.baylandinc.com

LAKE PLACID SPURS
SPUR 5
DONALD FOX
979 FOREST DRIVE
ARNOLD, MD 21012
SEPTEMBER 2024



WATER OAK POINT ROAD

EX. ACCESS ROAD

EX. EMBANKMENT

EX. WEIR BOX &
OUTFALL STRUCTURE
TO BE MAINTAINED

LIMIT OF
CONTAINMENT AREA

LAKE PLACID DREDGING
AT
ANNE ARUNDEL COUNTY

Main Channel:
24-WL-0055
202460071
104846
9/19/24
MT

APPL. BY: ANNE ARUNDEL COUNTY
DEPARTMENT OF PUBLIC WORKS

ROCK CREEK DMP SITE

DATE: SEPTEMBER 2024 PAGE 13 OF 15

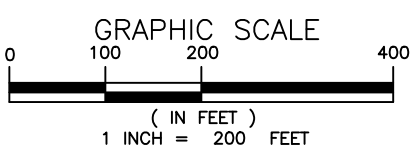

NOTES:
1. BASEMAP COMPILED FROM ANNE ARUNDEL
2016 PLANIMETRICS AND 2020 IMAGERY.
2. CURRENT AVAILABLE CAPACITY: 38,000 CY

Consultants & Designers, Inc.
"Integrating Engineering and Environment"
7455 New Ridge Road, Suite 1 Phone: (410) 694-9401
Hanover, Maryland 21076 Fax: (410) 694-9405
www.baylandinc.com

Z:\5_20401_LAKE_PLACID_DREDGING\CAD FILES\SHEET FILES\5_20401_JPA08.DWG



MECHANICAL UNLOADING POINT

LIMIT OF CONTAINMENT AREA

EX. PERIMETER DIKE

EX. WEIR BOX AND
OUTFALL STRUCTURE
TO BE MAINTAINED

LAKE PLACID DREDGING
AT
ANNE ARUNDEL COUNTY

Main Channel:
24-WL-0055
202460071
104846
9/19/24
MT

APPL. BY: ANNE ARUNDEL COUNTY
DEPARTMENT OF PUBLIC WORKS

SOUTH COUNTY DMP SITE

DATE: SEPTEMBER 2024 PAGE 14 OF 15

NOTES:
1. BASEMAP COMPILED FROM ANNE ARUNDEL
2016 PLANIMETRICS AND 2020 IMAGERY.

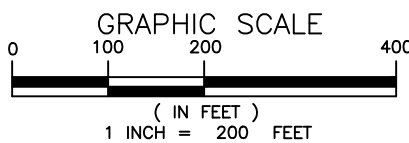

Bayland
Consultants & Designers, Inc.
"Integrating Engineering and Environment"

7455 New Ridge Road, Suite 1 Phone: (410) 694-9401
Hanover, Maryland 21076 Fax: (410) 694-9405
www.baylandinc.com

Z:\5_20401_LAKE_PLACID_DREDGING\CAD FILES\SHEET FILES\5_20401_JPA10.DWG

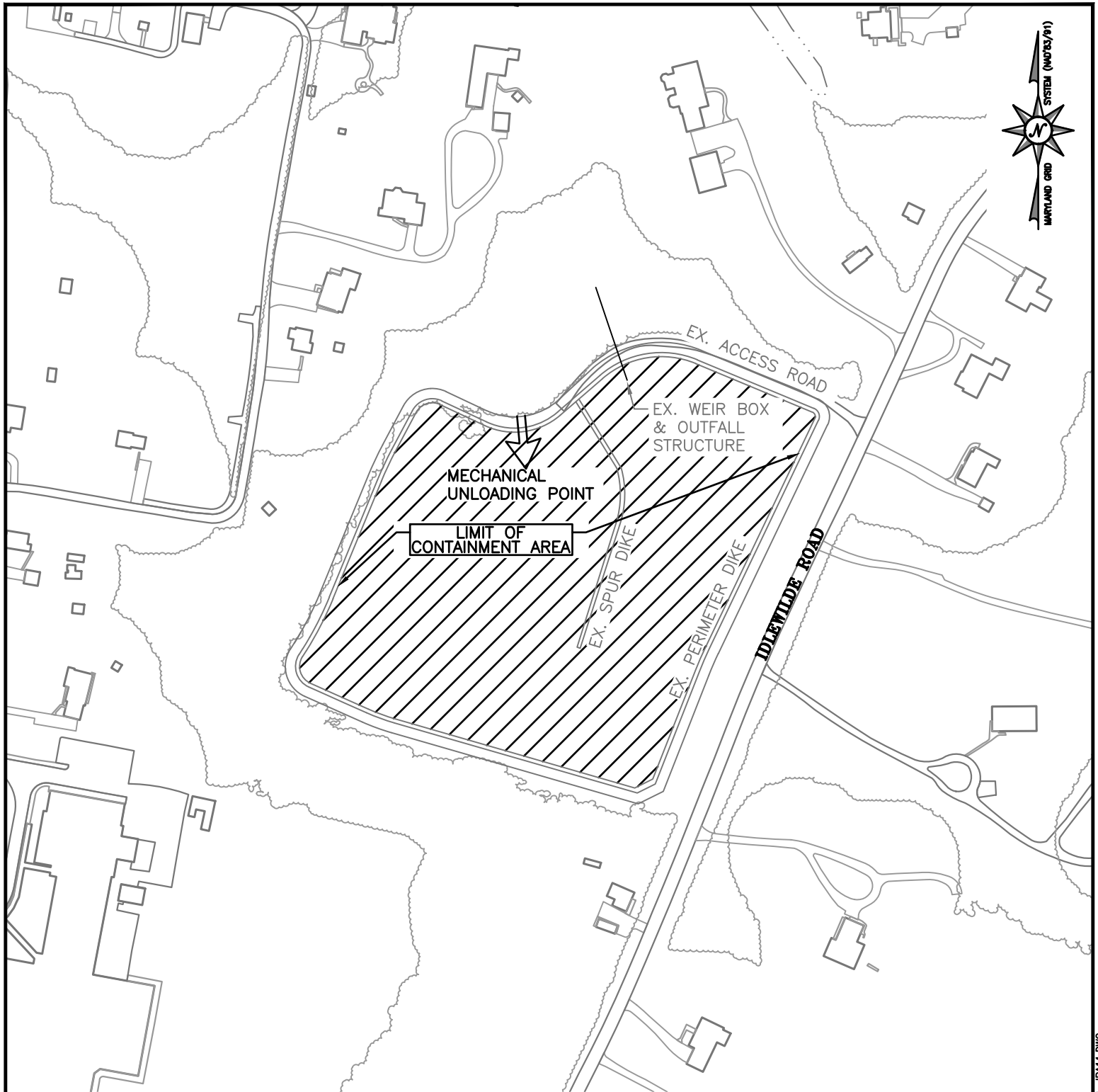

LAKE PLACID DREDGING
 AT
 ANNE ARUNDEL COUNTY

Main Channel:
 24-WL-0055
 202460071
 104846
 9/19/24
 MT

APPL. BY: ANNE ARUNDEL COUNTY
 DEPARTMENT OF PUBLIC WORKS

IDLEWILDE DMP SITE

DATE: SEPTEMBER 2024 **PAGE 15 OF 15**

NOTES:
 1. BASEMAP COMPILED FROM ANNE ARUNDEL
 2016 PLANIMETRICS AND 2020 IMAGERY.

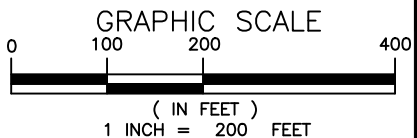

Bayland
 Consultants & Designers, Inc.
"Integrating Engineering and Environment"
 7455 New Ridge Road, Suite 1 Phone: (410) 694-9401
 Hanover, Maryland 21076 Fax: (410) 694-9405
 www.baylandinc.com

Z:\5_20401_LAKE_PLACID_DREDGING\CAD FILES\SHEET FILES\5_20401_JPA11.DWG